

i1 Installation manual - Recommended to read it first before installation of i1

Items delivered: i1 in-wall cabinet
 3 damping rings (2x10mm, 1x4mm)
 1 Manger Sound Transducer (MSW) Type W05/1,2.2.16
 4 screws M4x25
 1 Allen key 4mm (adjustment of mounting ring)
 1 Allen key 2mm (mounting MSW)
 optional: 1 cover
 1 removing tool for cover

Cabinet dimension w 435x h 390 x d 120mm
 (w 15.4" x h 17.1" x d 4.7")
 Cutout dimension \varnothing 221mm
 (\varnothing 8.7")

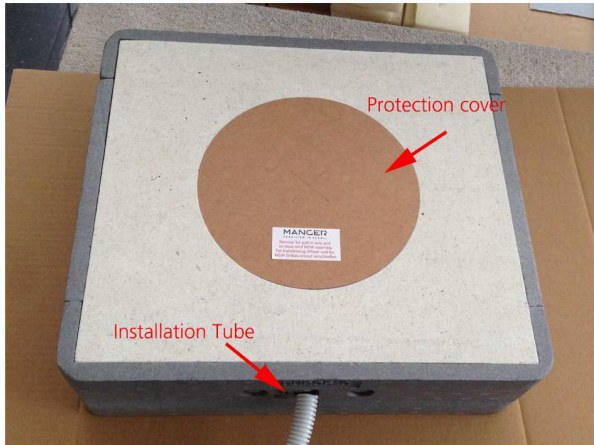

brick in i1 in-wall cabinet or install it in the wall
 installation tube should point in the direction of installed
 external speaker cable

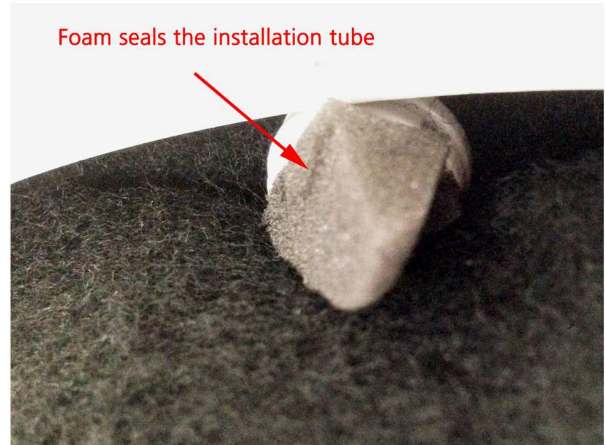

remove protection cover and foam of installation tube

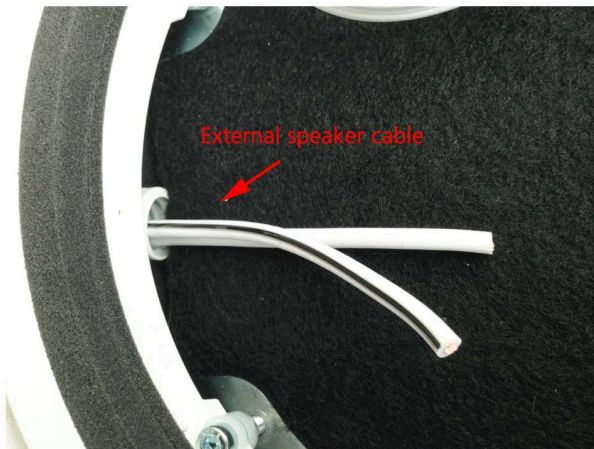

push the external speaker cable
 cable length pulled through should
 be around 200 - 300 mm (8 - 12")

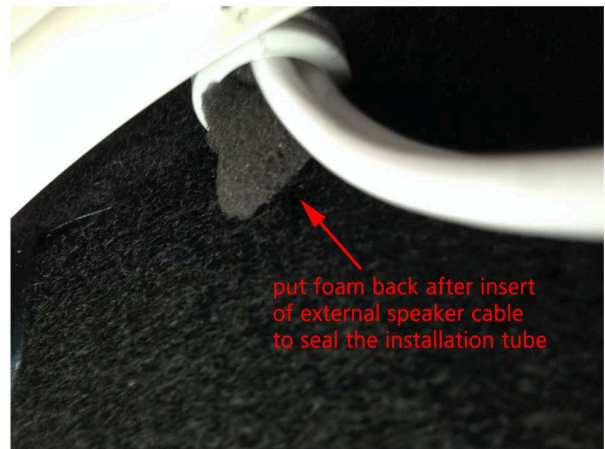

push foam into the installation tube to seal it

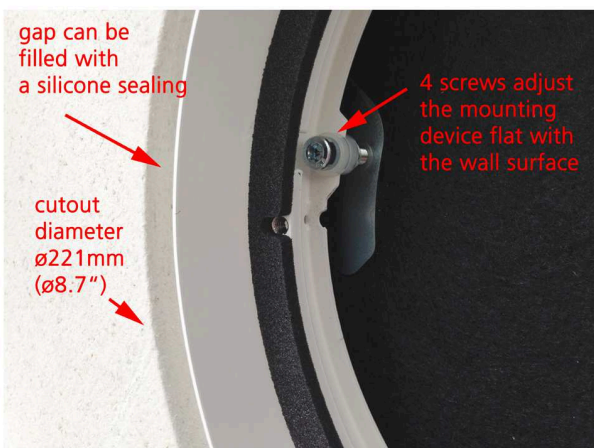

adjust the mounting ring so that is flat with the wall surface



reclose the cabinet with the protection cover
 finish the wall and fill the gap with silicone sealing

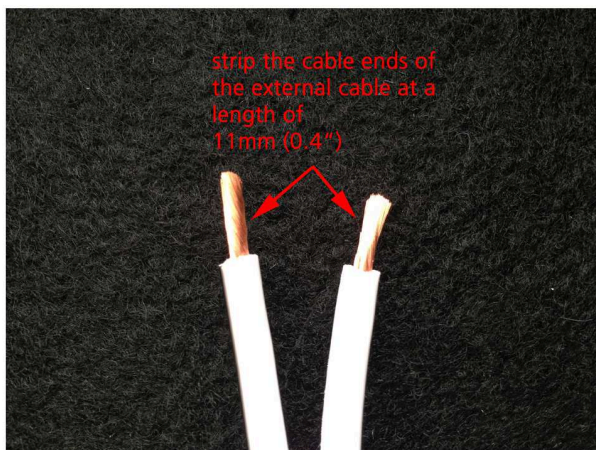

strip the cable ends of the external cable at a length of 11mm (0.4")

cable ends stripped at a length of 11mm
mark polarity (+), if the cable has no marking

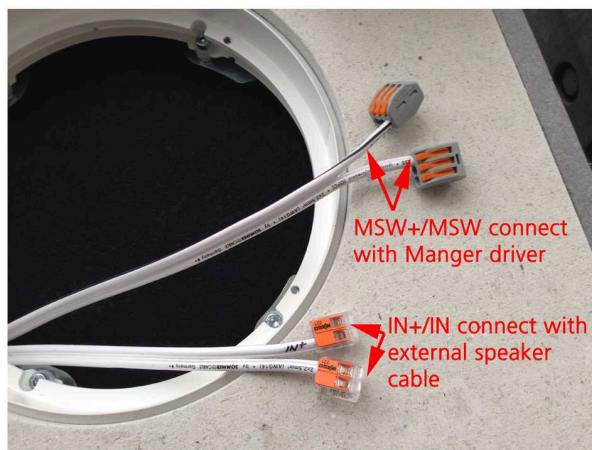

MSW+/MSW- connect with Manger driver

IN+/IN- connect with external speaker cable

internal connectors comes with clamps
lift the orange lever for open the clamps

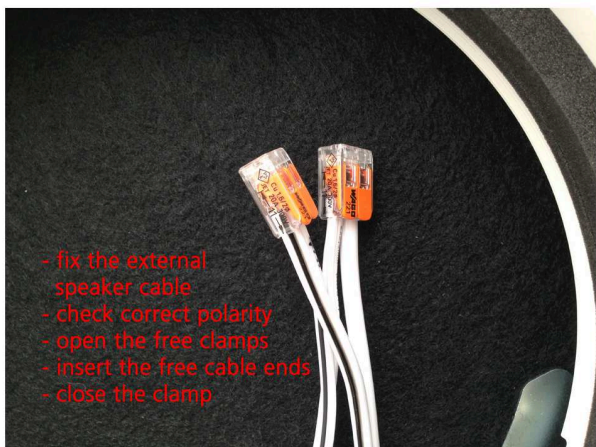

- fix the external speaker cable
- check correct polarity
- open the free clamps
- insert the free cable ends
- close the clamp

clamped the stripped ends of the external speaker cable into the free clamps of the IN+/IN- cables



flush-mounted MSW:
2 x 10mm ring
+ 1 x 4mm ring

MSW with cover:
1 x 10mm ring
+ 1 x 4mm ring

(photo shows
1 x 10mm ring
+ 1 x 4mm ring)

cut-out of damping ring in line with the threads

insert the black damping rings, like described in the photo
!IMPORTANT! This has to be done for connecting the MSW!



open clamps for connecting the MSW

clean the interior to avoid any damage on the MSW
unpack the MSW carefully (Attention! Strong magnet!)
connect the MSW

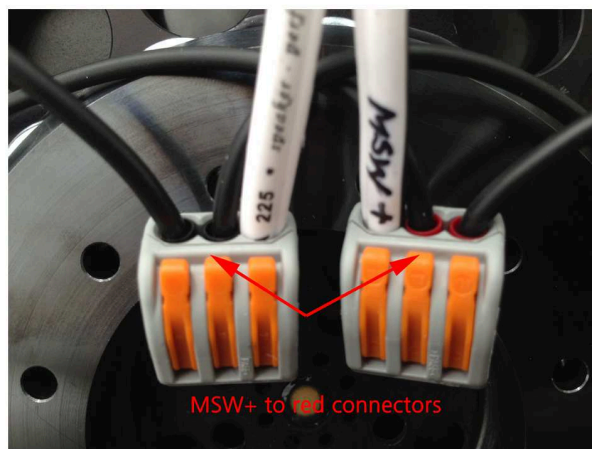

MSW+ to red connectors

hold the MSW upside down, so that the MSW connectors can be clamped - see photo

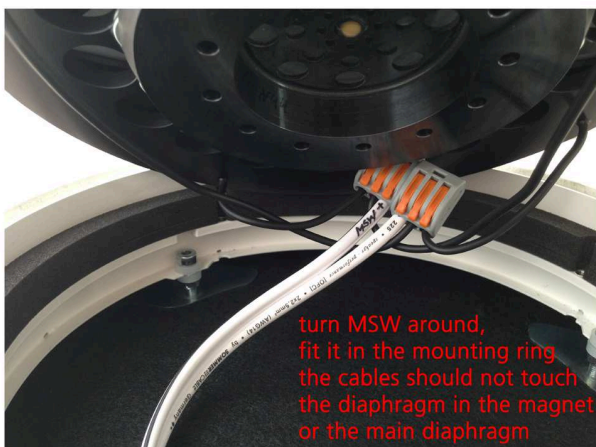

turn MSW around, fit it in the mounting ring the cables should not touch the diaphragm in the magnet or the main diaphragm

turn the MSW around - push the internal cable below the mounting ring - check that the holes are at the right position



use the Allen key to center the mounting hole with the thread; fix the MSW with the M4 screws

place the MSW in the cabinet, adjust the MSW with the Allen key; don't fix the MSW too strong as the damping rings are soft and will be compressed